

Hinge and Strike Spacing

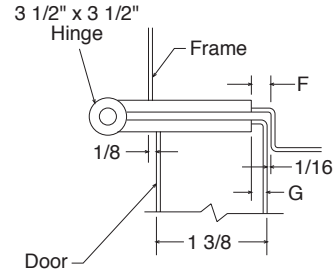

3-1/2 Hinge & Strike Comparison for 1-3/8" Thick Doors

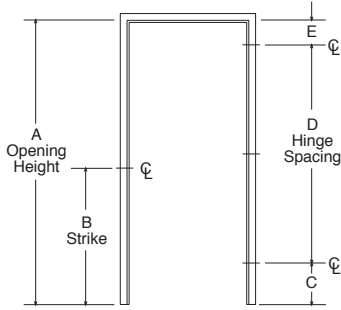

MANUFACTURER	A	B	C	D	E	F	G
AMWELD	6'-8"	40-5/16"	10-3/8"	59-7/8"	9-3/4"	5/16"	1/4"
	6'-10"		12-3/8"	59-7/8"			
	7'-0"		14-3/8"	59-7/8"			
	7'-2"		16-3/8"	59-7/8"			
	6'-8"		10-3/8"	2 @ 29-15/16"			
	6'-10"		12-3/8"	2 @ 29-15/16"			
	7'-0"		14-3/8"	2 @ 29-15/16"			
	7'-2"		16-3/8"	2 @ 29-15/16"			
CECO (1)	6'-8"	40-5/16"	10-3/8"	2 @ 29-15/16"	9-3/4"	5/16"	N/A
	7'-0"			2 @ 31-15/16"			
	7'-2"			2 @ 32-15/16"			
CURRIES (2)	6'-8"	40-5/16"	10-3/8"	2 @ 29-15/16"	9-3/4"	5/16"	1/4"
	6'-10"		10-3/8"	2 @ 30-15/16"			
	7'-0"		10-3/8"	2 @ 31-15/16"			
	7'-2"		10-3/8"	2 @ 32-15/16"			
	7'-4"		10-3/8"	2 @ 33-15/16"			
	7'-6"		10-3/8"	2 @ 34-15/16"			
	7'-8"		10-1/4"	3 @ 24"			
	7'-10"		10-3/8"	3 @ 24-5/8"			
8'-0"	10-1/8"	3 @ 25-3/8"					
DEANSTEEL	6'-8"	40-5/16"	11-3/4"	61-1/2"	6-3/4"	5/16"	1/4"
	6'-10"			2 @ 31-3/4"			
	7'-0"			2 @ 32-3/4"			
	7'-2"			2 @ 33-3/4"			

Cautionary Statement

The hinge and strike spacings presented in this brochure are intended as a reference to inform the reader of the standard locations used in the manufacture of steel doors and frames by SDI member companies for the opening sizes shown.

The user must be aware that these spacings shall not be relied upon when retrofitting doors or frames to an existing installation. Field verification of hinge and strike spacings in this situation is necessary.

Dimensions listed are valid at the time of publication. However, manufacturers do periodically revise their hinge and strike spacing, therefore, the SDI strongly recommends that individual manufacturers be contacted to verify dimensions.

The Steel Door Institute and its member companies shall not be held liable for products manufactured using the information published here.

3-1/2 Hinge & Strike Comparison for 1-3/8" Thick Doors

MANUFACTURER	A	B	C	D	E	F	G
KEWANEE	6'-8" 6'-10" 7'-0" 7'-2" 7'-4" 7'-6" 7'-8" 7'-10" 8'-0"	40-5/16"	10-1/4"	60-1/8" 62-1/8" 2 @ 32-1/16" 2 @ 33-1/16" 2 @ 34-1/16" 2 @ 35-1/16" 3 @ 24-1/16", 24", 24-1/16" 3 @ 24-11/16", 24-3/4", 24-11/16" 3 @ 25-3/8"	9-5/8"	1/4"	3/16"
MESKER	6'-8" 7'-0" 7'-2"	40-5/16"	11-3/4"	61-1/2" 2 @ 32-3/4" 2 @ 33-3/4"	6-3/4"	1/4"	3/16"
PIONEER	6'-8" 6'-10" 7'-0" 7'-2" 7'-4" 7'-6" 7'-8" 7'-10" 8'-0"	38"	11-3/4" 11-3/4" 11-3/4" 11-3/4" 11-3/4" 11-13/16" 11-3/4" 11-11/16" 11-13/16"	2 @ 30-3/4" 2 @ 31-3/4" 2 @ 32-3/4" 2 @ 33-3/4" 2 @ 34-3/4" 3 @ 23-13/16" 3 @ 24-1/2" 3 @ 25-3/16" 3 @ 25-13/16"	6-3/4"	5/16"	7/32"
REPUBLIC	6'-8" 6'-10" 7'-0" 7'-2" 7'-4" 7'-6" 7'-8" 7'-10" 8'-0"	40-5/16"	10-3/8" 12-1/4" 12-3/8" 12-3/8" 12-1/4" 12-1/4" 12-3/8" 12-3/8" 12-1/8" 12-1/4"	2 @ 29-15/16" 2 @ 31-1/4" 2 @ 29-15/16" 2 @ 30-15/16" 2 @ 34-1/4" 2 @ 35-1/4" 3 @ 24-1/8" 3 @ 24-7/8" 3 @ 25-1/2"	9-3/4" 7-1/4" 11-3/4" 11-3/4" 7-1/4" 7-1/4" 7-1/4" 7-1/4" 7-1/4" 7-1/4"	5/16"	1/4"
SECURITY METAL PRODUCTS (3)	—	—	—	—	—	—	—
STEELCRAFT	6'-8" 7'-0" 7'-2" 7'-10" 8'-0"	40-5/16"	10-3/8"	59-7/8" 2 @ 31-15/16" 2 @ 32-15/16" 3 @ 24-5/8" 3 @ 25-19/64"	9-3/4"	5/16"	1/4"

Notes:

(1) Does not manufacturer 1-3/8" thick steel doors. Steel frames are manufactured for 1-3/8" thick wood doors.

(2) Doors of all heights are also available with two hinges. C & E dimensions are same as shown.

(3) Does not manufacture 1-3/8" thick steel doors. Steel frames for 1-3/8" thick wood doors are manufactured by special arrangement only.

4-1/2 Hinge & Strike Comparison for 1-3/4" Thick Doors

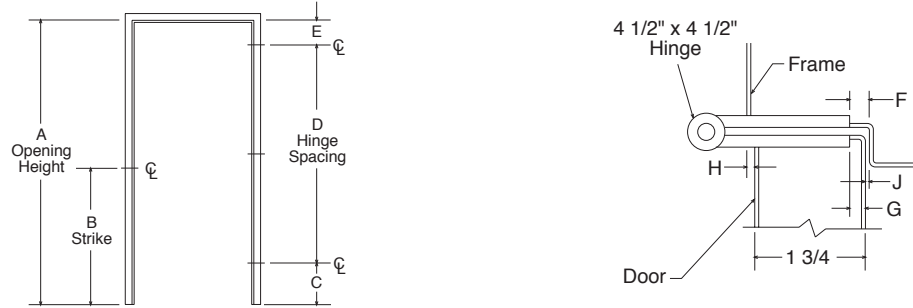

MANUFACTURER	A	B	C	D	E	F	G	H	J
AMWELD	6'-8"	40-5/16"	10-3/8"	2 @ 29-15/16"	9-3/4"	5/16"	3/16"	1/16"	1/8"
	6'-10"		8-3/8"	2 @ 31-15/16"					
	7'-0"		10-3/8"	2 @ 31-15/16"					
	7'-2"		12-3/8"	2 @ 31-15/16"					
	7'-4"		10-3/8"	2 @ 33-15/16"					
	7'-6"		12-3/8"	2 @ 33-15/16"					
	7'-8"		10-7/16"	3 @ 23-15/16"					
	7'-10"		8-5/16"	3 @ 25-5/16"					
	8'-0"		10-5/16"	3 @ 25-5/16"					
	BENCHMARK		6'-8"	40-5/16"					
6'-10"		14-1/4"	2 @ 30-1/4"						
7'-0"		12-1/4"	2 @ 32-1/4"						
7'-2"		14-1/4"	2 @ 32-1/4"						
7'-4"		12-1/4"	2 @ 34-1/4"						
7'-6"		14-1/4"	2 @ 34-1/4"						
7'-8"		8-1/4"	3 @ 25-1/2"						
7'-10"		10-1/4"	3 @ 25-1/2"						
8'-0"		12-1/4"	3 @ 25-1/2"						
CECO		6'-8"	41-13/16"		9"	2 @ 31"	9"	5/16"	1/4"
	6'-10"	2 @ 32"							
	7'-0"	2 @ 33"							
	7'-2"	2 @ 34"							
	7'-4"	2 @ 35"							
	7'-6"	2 @ 36"							
	7'-8"	3 @ 24-21/32"							
	7'-10"	3 @ 25-21/64"							
	8'-0"	3 @ 26"							
	CURRIES	6'-8"		40"		12-1/4"			
6'-10"		12-1/4"	2 @ 31-1/4"						
7'-0"		12-1/4"	2 @ 32-1/4"						
7'-2"		12-1/4"	2 @ 33-1/4"						
7'-4"		12-1/4"	2 @ 34-1/4"						
7'-6"		12-1/4"	2 @ 35-1/4"						
7'-8"		12-3/8"	3 @ 24-1/8"						
7'-10"		12-1/8"	3 @ 24-7/8"						
8'-0"		12-1/4"	3 @ 25-1/2"						
DEANSTEEL		6'-8"	40-5/16"		12-1/4"	2 @ 30-1/4"	7-1/4"	5/16"	1/4"
	6'-10"	2 @ 31-1/4"							
	7'-0"	2 @ 32-1/4"							
	7'-2"	2 @ 33-1/4"							
	7'-4"	2 @ 34-1/4"							
	7'-6"	2 @ 35-1/4"							
	7'-8"	24-1/8", 24-1/4", 24-1/8"							
	7'-10"	24-7/8", 24-3/4", 24-7/8"							
	8'-0"	3 @ 25-1/2"							

4-1/2 Hinge & Strike Comparison for 1-3/4" Thick Doors

MANUFACTURER	A	B	C	D	E	F	G	H	J
KEWANEE	6'-8" 6'-10" 7'-0" 7'-2" 7'-4" 7'-6" 7'-8" 7'-10" 8'-0"	40-5/16"	10-1/4"	2 @ 30-1/16" 2 @ 31-1/16" 2 @ 32-1/16" 2 @ 33-1/16" 2 @ 34-1/16" 2 @ 35-1/16" 24-1/16", 24", 24-1/16" 24-11/16", 24-3/4", 24-11/16" 3 @ 25-3/8"	9-5/8"	3/8"	1/4"	1/16"	1/8"
MESKER	6'-8" 6'-10" 7'-0" 7'-2" 7'-4" 7'-6" 7'-8" 7'-10" 8'-0"	40-5/16"	12-1/4" 12-1/4" 12-1/4" 12-1/4" 12-1/4" 12-1/4" 11-1/4" 10-1/4" 12-1/4"	2 @ 30-1/4" 2 @ 31-1/4" 2 @ 32-1/4" 2 @ 33-1/4" 2 @ 34-1/4" 2 @ 35-1/4" 3 @ 24-1/2" 3 @ 25-1/2" 3 @ 25-1/2"	7-1/4"	5/16"	1/4"	1/8"	1/16"
PIONEER	6'-8" 6'-10" 7'-0" 7'-2" 7'-4" 7'-6" 7'-8" 7'-10" 8'-0"	38"	12-1/4" 12-1/4" 12-1/4" 12-1/4" 12-1/4" 12-3/16" 12-5/16" 12-1/4"	2 @ 30-1/4" 2 @ 31-1/4" 2 @ 32-1/4" 2 @ 33-1/4" 2 @ 34-1/4" 3 @ 23-1/2" 3 @ 24-3/16" 3 @ 24-13/16" 3 @ 25-1/2"	7-1/4"	5/16"	7/32"	3/32"	3/32"
REPUBLIC	6'-8" 6'-10" 7'-0" 7'-2" 7'-4" 7'-6" 7'-8" 7'-10" 8'-0"	40-5/16"	10-3/8" 12-1/4" 12-3/8" 12-3/8" 12-1/4" 12-1/4" 12-3/8" 12-1/8" 12-1/4"	2 @ 29-15/16" 2 @ 31-1/4" 2 @ 29-15/16" 2 @ 30-15/16" 2 @ 34-1/4" 2 @ 35-1/4" 3 @ 24-1/8" 3 @ 24-7/8" 3 @ 25-1/2"	9-3/4" 7-1/4" 11-3/4" 11-3/4" 7-1/4" 7-1/4" 7-1/4" 7-1/4" 7-1/4"	5/16"	1/4"	1/8"	1/16"
SECURITY METAL PRODUCTS	6'-8" 6'-10" 7'-0" 7'-2" 7'-4" 7'-6" 7'-8" 7'-10" 8'-0"	40-5/16"	12-1/4" 12-1/4" 12-1/4" 12-1/4" 12-1/4" 10-1/4" 12-1/4" 12-1/4" 12-1/4"	2 @ 30-1/4" 2 @ 31-1/4" 2 @ 32-1/4" 2 @ 33-1/4" 2 @ 34-1/4" 2 @ 36-1/4" 3 @ 24-11/64" 3 @ 24-53/64" 3 @ 25-1/2"	7-1/4"	3/8"	1/4"	1/16"	1/8"
STEELCRAFT	6'-8" 6'-10" 7'-0" 7'-2" 7'-4" 7'-6" 7'-8" 7'-10" 8'-0"	40-5/16"	10-3/8"	2 @ 29-15/16" 2 @ 30-15/16" 2 @ 31-15/16" 2 @ 32-15/16" 2 @ 33-15/16" 2 @ 34-15/16" 3 @ 23-61/64" 3 @ 24-5/8" 3 @ 25-19/64"	9-3/4"	5/16"	1/4"	1/8"	1/16"

5" Hinge & Strike Comparison for 1-3/4" Thick Doors

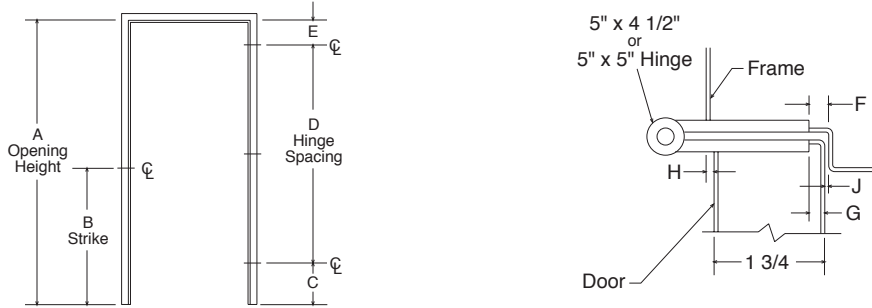

MANUFACTURER	A	B	C	D	E	F	G	H	J
AMWELD	6'-8"	40-5/16"	10-3/8"	2 @ 29-15/16"	9-3/4"	5/16"	3/16"	1/16"	1/8"
	6'-10"		8-3/8"	2 @ 31-15/16"					
	7'-0"		10-3/8"	2 @ 31-15/16"					
	7'-2"		12-3/8"	2 @ 31-15/16"					
	7'-4"		10-3/8"	2 @ 33-15/16"					
	7'-6"		12-3/8"	2 @ 33-15/16"					
	7'-8"		10-7/16"	3 @ 23-15/16"					
	7'-10"		8-5/16"	3 @ 25-5/16"					
	8'-0"		10-5/16"	3 @ 25-5/16"					
CECO	6'-8"	41-13/16"	9"	2 @ 31"	9"	5/16"	1/4"	1/8"	1/16"
	6'-10"			2 @ 32"					
	7'-0"			2 @ 33"					
	7'-2"			2 @ 34"					
	7'-4"			2 @ 35"					
	7'-6"			2 @ 36"					
	7'-8"			3 @ 24-21/32"					
	7'-10"			3 @ 25-21/64"					
	8'-0"			3 @ 26"					
CURRIES	6'-8"	40"	12-1/4"	2 @ 30-1/4"	7-1/4"	5/16"	1/4"	1/8"	1/16"
	6'-10"		12-1/4"	2 @ 31-1/4"					
	7'-0"		12-1/4"	2 @ 32-1/4"					
	7'-2"		12-1/4"	2 @ 33-1/4"					
	7'-4"		12-1/4"	2 @ 34-1/4"					
	7'-6"		12-1/4"	2 @ 35-1/4"					
	7'-8"		12-3/8"	3 @ 24-1/8"					
	7'-10"		12-1/8"	3 @ 24-7/8"					
	8'-0"		12-1/4"	3 @ 25-1/2"					
DEANSTEEL	6'-8"	40-5/16"	12-1/2"	2 @ 30"	7-1/2"	5/16"	1/4"	1/8"	1/16"
	6'-10"			2 @ 31"					
	7'-0"			2 @ 32"					
	7'-2"			2 @ 33"					
	7'-4"			2 @ 34"					
	7'-6"			2 @ 35"					
	7'-8"			3 @ 24"					
	7'-10"			24-5/8", 24-3/4", 24-5/8"					
	8'-0"			25-3/8", 25-1/4", 25-3/8"					
KEWANEE	6'-8"	40-5/16"	10-1/4"	2 @ 30-1/16"	9-5/8"	3/8"	1/4"	1/16"	1/8"
	6'-10"			2 @ 31-1/16"					
	7'-0"			2 @ 32-1/16"					
	7'-2"			2 @ 33-1/16"					
	7'-4"			2 @ 34-1/16"					
	7'-6"			2 @ 35-1/16"					
	7'-8"			24-1/16", 24", 24-1/16"					
	7'-10"			24-11/16", 24-3/4", 24-11/16"					
	8'-0"			3 @ 25-3/8"					

5" Hinge & Strike Comparison for 1-3/4" Thick Doors

MANUFACTURER	A	B	C	D	E	F	G	H	J
MESKER	6'-8" 6'-10" 7'-0" 7'-2" 7'-4" 7'-6" 7'-8" 7'-10" 8'-0"	40-5/16"	12-1/4" 12-1/4" 12-1/4" 12-1/4" 12-1/4" 12-1/4" 11-1/4" 10-1/4" 12-1/4"	2 @ 30-1/4" 2 @ 31-1/4" 2 @ 32-1/4" 2 @ 33-1/4" 2 @ 34-1/4" 2 @ 35-1/4" 3 @ 24-1/2" 3 @ 25-1/2" 3 @ 25-1/2"	7-1/4"	5/16"	1/4"	1/8"	1/16"
PIONEER	6'-8" 6'-10" 7'-0" 7'-2" 7'-4" 7'-6" 7'-8" 7'-10" 8'-0"	38"	12-1/2" 12-1/2" 12-1/2" 12-1/2" 12-1/2" 12-9/16" 12-1/2" 12-5/8" 12-9/16"	2 @ 30" 2 @ 31" 2 @ 32" 2 @ 33" 2 @ 34" 3 @ 23-5/16" 3 @ 24" 3 @ 24-5/8" 3 @ 25-5/16"	7-1/2"	5/16"	7/32"	3/32"	3/32"
REPUBLIC	6'-8" 6'-10" 7'-0" 7'-2" 7'-4" 7'-6" 7'-8" 7'-10" 8'-0"	40-5/16"	10-3/8" 12-1/4" 12-3/8" 12-3/8" 12-1/4" 12-1/4" 12-3/8" 12-1/8" 12-1/4"	2 @ 29-15/16" 2 @ 31-1/4" 2 @ 29-15/16" 2 @ 30-15/16" 2 @ 34-1/4" 2 @ 35-1/4" 3 @ 24-1/8" 3 @ 24-7/8" 3 @ 25-1/2"	9-3/4" 7-1/4" 11-3/4" 11-3/4" 7-1/4" 7-1/4" 7-1/4" 7-1/4" 7-1/4"	5/16"	1/4"	1/8"	1/16"
SECURITY METAL PRODUCTS	6'-8" 6'-10" 7'-0" 7'-2" 7'-4" 7'-6" 7'-8" 7'-10" 8'-0"	40-5/16"	12-1/2" 12-1/2" 12-1/2" 12-1/2" 12-1/2" 10-1/2" 12-1/2" 12-1/2" 12-1/2"	2 @ 30" 2 @ 31" 2 @ 32" 2 @ 33" 2 @ 34" 2 @ 36" 3 @ 24" 3 @ 24-43/64" 3 @ 25-21/64"	7-1/2"	3/8"	1/4"	1/16"	1/8"
STEELCRAFT	6'-8" 6'-10" 7'-0" 7'-2" 7'-4" 7'-6" 7'-8" 7'-10" 8'-0"	40-5/16"	10-3/8"	2 @ 29-15/16" 2 @ 30-15/16" 2 @ 31-15/16" 2 @ 32-15/16" 2 @ 33-15/16" 2 @ 34-15/16" 3 @ 23-61/64" 3 @ 24-5/8" 3 @ 25-19/64"	9-3/4"	5/16"	1/4"	1/8"	1/16"

Note: Dimensions listed are valid at time of publication. However, manufacturers do periodically revise their hinge and strike spacing, therefore, the SDI strongly recommends that individual manufacturers be contacted to verify dimensions.

AVAILABLE PUBLICATIONS

Specifications

- ANSI/SDI A250.6** Recommended Practice for Hardware Reinforcings on Standard Steel Doors and Frames
- ANSI/SDI A250.8** SDI 100 Recommended Specifications for Standard Steel Doors & Frames
- SDI-108** Recommended Selection & Usage Guide for Standard Steel Doors
- SDI-109** Hardware for Standard Steel Doors & Frames
- SDI-118** Basic Fire Door Requirements
- SDI-128** Guidelines for Acoustical Performance of Standard Steel Doors & Frames
- SDI-129** Hinge & Strike Spacing

Test Procedures

- ANSI/SDI A250.3** Test Procedure & Acceptance Criteria for Factory Applied Finish Coatings for Steel Doors & Frames
- ANSI/SDI A250.4** Test Procedure & Acceptance Criteria for Physical Endurance for Steel Doors, Frames, Frame Anchors & Hardware Reinforcings
- ANSI/SDI A250.10** Test Procedure & Acceptance Criteria for Prime Painted Steel Surfaces for Steel Doors & Frames
- ANSI/SDI A250.13** Testing and Rating of Severe Windstorm Resistant Components for Swinging Door Assemblies
- SDI-113** Standard Practice for Determining the Steady State Thermal Transmittance of Steel Door & Frame Assemblies
- SDI-131** Accelerated Physical Endurance Test Procedure for Steel Doors, Frames and Frame Anchors

Construction Details

- ANSI/SDI A250.11** Recommended Erection Instructions for Steel Frames
- SDI-110** Standard Steel Doors & Frames for Modular Masonry Construction
- SDI-111** Recommended Details for Standard Details Steel Doors, Frames, Accessories and Related Components
- SDI-122** Installation & Troubleshooting Guide for Standard Steel Doors & Frames
- SDI** Drywall Slip-On Frames

Miscellaneous Documents

- ANSI/SDI A250.7** Nomenclature for Standard Steel Doors & Steel Frames
- SDI-106** Recommended Standard Door Type Nomenclature
- SDI-112** Zinc-Coated (Galvanized/Galvannealed) Standard Steel Doors & Frames
- SDI-117** Manufacturing Tolerances for Standard Steel Doors & Frames
- SDI-124** Maintenance of Standard Steel Doors & Frames
- SDI-127** Industry Alert Series (A-L)
- SDI-130** Electrified Hinge Preparations
- SDI** What is The SDI?

AUDIO-VISUAL PROGRAMS ON VHS ALSO AVAILABLE



Standards As Tough As Steel.™

MEMBERS OF THE STEEL DOOR INSTITUTE

AMWELD INTERNATIONAL, LLC
301 South Northpoint Drive, Suite 400
Coppell, TX 75019
(888) 775-2397
www.amweld.com

CECO DOOR PRODUCTS
9159 Telecom Drive
Milan, TN 38358
(731) 686-8345
www.cecodoor.com

CURRIES COMPANY
P.O. Box 1648
Mason City, IA 50402-1648
(641) 423-1334
www.curries.com

DEANSTEEL MANUFACTURING CO.
111 Merchant Street
San Antonio, TX 78204-1496
(210) 226-8271
www.deansteel.com

DOOR COMPONENTS INC.
7980 Redwood Avenue
Fontana, CA 92336-1638
(909) 770-5700
www.doorcomponents.com

MESKER DOOR, INC.
3440 Stanwood Boulevard
Huntsville, AL 35811-9021
(256) 851-6670
www.meskerdoor.com

METAL PRODUCTS, INC.
319 North Hills Road
Corbin, KY 40701
(606) 523-0173
www.metalproductsinc.com

PIONEER INDUSTRIES, INC.
171 South Newman Street
Hackensack, NJ 07601
(201) 933-1900
www.pioneerindustries.com

REPUBLIC
155 Republic Drive
McKenzie, TN 38201-0580
(731) 352-3383
www.republicdoor.com

SECURITY METAL PRODUCTS CORP.
5700 Hannum Avenue, Suite 250
Culver City, CA 90230
(310) 641-6690
www.secmet.com

STEELCRAFT
Ingersoll Rand Security Technologies
9017 Blue Ash Road
Cincinnati, OH 45242
(513) 745-6400
www.steelcraft.com

STEEL DOOR INSTITUTE

30200 DETROIT ROAD • CLEVELAND, OHIO 44145

440.899.0010 • FAX 440.892.1404

www.steeldoor.org